

Safe-T-Lift™ for Pull Style Tarping System



The Safe-T-Lift™ is an easy-to-use spring and arm system that lifts the rear pull bar over the load. It is easier and safer to operate than a standard pull style tarp system alone. Its spring-tensioned arms use a light single spring on each side, permitting the driver to easily pull the tarp and walk it to the back.

The Safe-T-Lift allows the driver to deploy or stow the tarp quickly from ground level increasing safety and productivity without adding significant cost or complexity to the system.



US Tarp now provides 16-ft and 18-ft options, ideal for 8-ft to 10-ft high-body sidewall trucks, widely used by state Department of Transportations across the country. Because the truck sidewalls are tall and loads can be coarse, conventional pull style systems can be difficult to deploy.

Safe-T-Lift is a first-fit option for new dump body installations and can be easily retrofit by distributors or dealers to most conventional pull style tarp systems.

Safe-T-Lift™

Steel Arm Kit for Pull Style Assist Arms

Part #16218

Steel Arm Kit for Pull Style Assist/Bent Arms

Part #16218-BA

Alum Arm Kit for Pull Style Assist Arms

Part #16230

Alum Arm Kit for Pull Style Assist/Bent Arms

Part #16230-BA

Safe-T-Lift™ Arm Kit

The Safe-T-Lift is available in Steel or Aluminum Arm Kits.

**Steel Arm Kit
Part #16218**

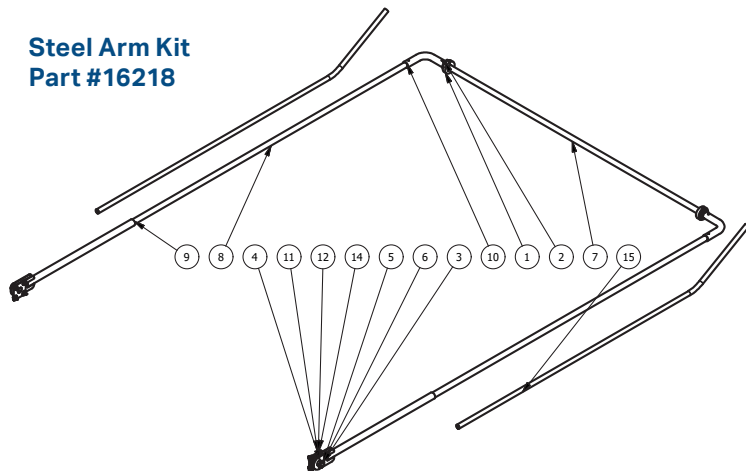

**Aluminum Arm Kit
Part #16230**

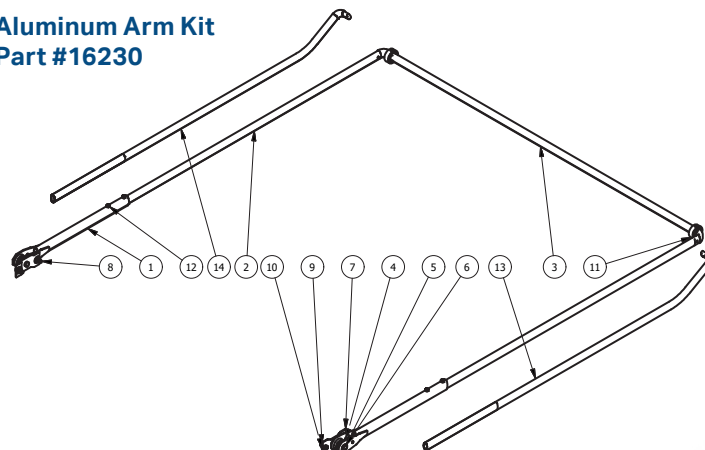

STEEL ARM KIT - Part #16218

Item	Qty	Part #	Description
1	2	13941	Rubber Tarp Centering Flange
2	2	13913	Hose Clamp
3	2	14470	Tension Hoop Mounting Pin
4	2	11121	Spiral Torsion Spring
5	2	11142	Retaining Ring
6	4	11141	Stainless Steel Bushing
7	1	11269	Steel Cross Tube, 96" Long
8	2	11268	Steel Upper Side Arm, 120" Long
9	2	14471-36	Tension Hoop Pivot Arm with Zinc Platng, 36"
10	2	11267	Steel 90° Corner
11	8	11273	3/8"-16 x 1" Grade 5 Hex Bolt
12	8	11275	3/8" Nylock Nut
14	8	11274	3/8" Flat Washer

OPTIONAL BENT STEEL ARM KIT - Part #16218-BA

15	2	11268-BA	30° Bent Steel Upper Side Arm, 120" Long
----	---	----------	--

ALUMINUM ARM KIT - Part #16230

Item	Qty	Part #	Description
1	2	13941	3 Spring Lower Aluminum Arm, 31" Long
2	2	13913	Aluminum Side Arm with Corner
3	1	14470	Aluminum Side Arm 98" Long - Optional Ben Arm (BA)
4	2	11121	Spiral Torsion Spring
5	4	11141	Stainless Steel Bushing
6	2	11142	Retaining Ring
7	2	11269	3 Spring Pivot Pin
8	4	11268	5/8"-11x1/2" Grade 5 Hex Bolt
9	4	14471-36	5/8"-11 Nylock Nut
10	4	11267	5/8" Flat Washer
11	2	11273	Plastic Tarp Centering Flange - Black
12	4	11275	1/2"-12x1" Grade 5 Hex Cap Screw

OPTIONAL BENT ALUMINUM KIT - Part #16230-BA

13	1	11236-BA-L	Aluminum Side Arm with Corner, Bent Driver Side Left
14	1	11236-BA-R	Aluminum Side Arm with Corner, Bent Passenger Side Right

Safe-T-Lift™

phone: 800-249-0297 | fax: 269-639-3015
email: Sales@USTarp.com