

Tension Bow

INSTALLATION INSTRUCTION MANUAL

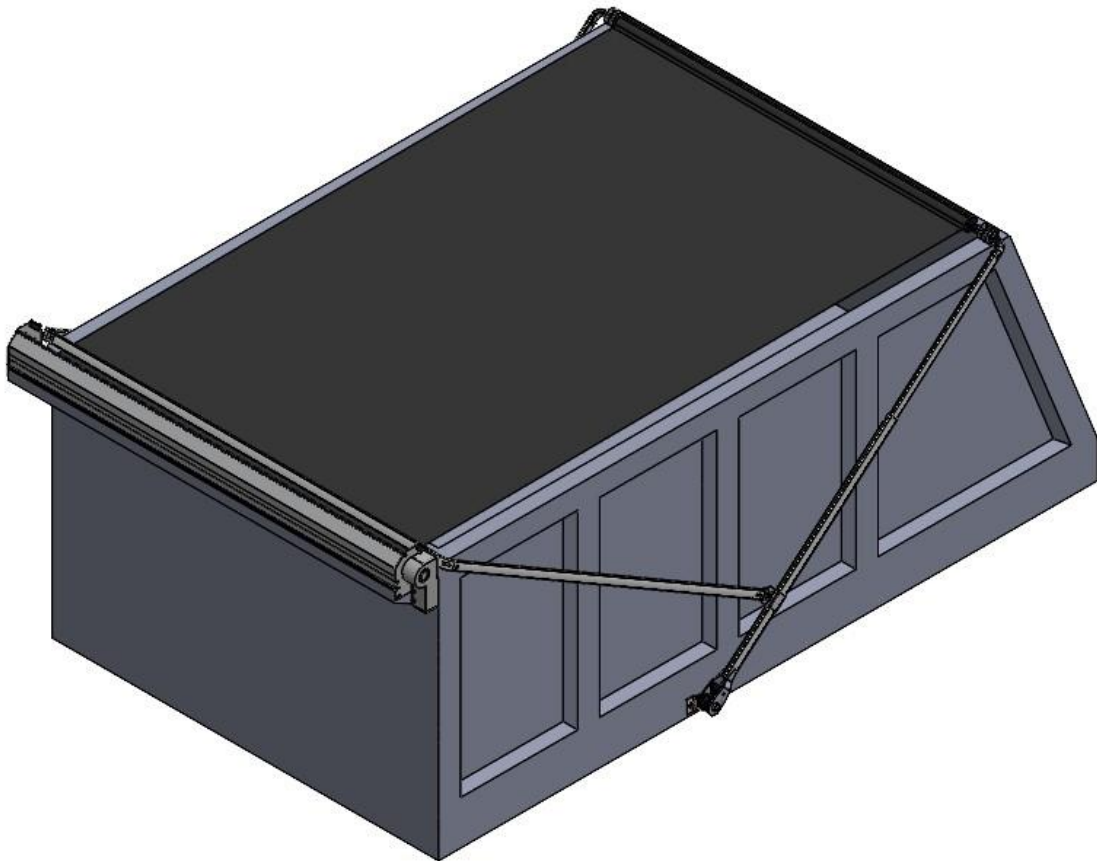



Table of Contents

SAFETY.....	3
STEP 1: INSTALLING THE MOUNTING BRACKET	4
FINDING THE TENSION BOW PIVOT POINT	4
ASSEMBLING THE MOUNTING BRACKET AND TAB	5
STEP 2: INSTALLING THE TENSION BOW ARMS	5
DRILLING MOUNTING HOLES	6
MOUNTING THE TENSION BOW ARMS	6
STEP 3: INSTALLING THE TENSION BOW CROSS TUBE	7
DRILLING MOUNTING HOLES	7
CONNECTING THE TENSION BOW CROSS TUBE	7
STEP 4: FINAL ADJUSTMENTS	8
BOW POSITIONING	8
BOW PINCHING	8

SAFETY

Read this section carefully before proceeding. The following symbols may appear prior to certain safety related assembly and installation steps described in this manual.

FAILURE TO OPERATE AND INSTALL THIS UNIT AS INSTRUCTED MAY RESULT IN SERIOUS INJURY OR DEATH.

 DANGER
Indicates an immediately hazardous situation which, if not avoided, will result in serious injury or death.

 WARNING
Indicates a potentially hazardous situation which, if not avoided, could result in serious injury or death.

 CAUTION
Indicates a potentially hazardous situation which, if not avoided, may result in minor or moderate injury or property damage.

NOTICE
Indicates information about a subject that is not safety related.

Step 1: Installing the Mounting Brackets

Remove the upper arms (2) from the lower pivot arms (1) along with their associated hardware (3) so the tension bow mounting brackets (4) can slide onto the lower pivot arm. Slide the brackets on such that the flat surface of the mounting bracket is towards the dump box. Reattach the upper and lower pivot arms.

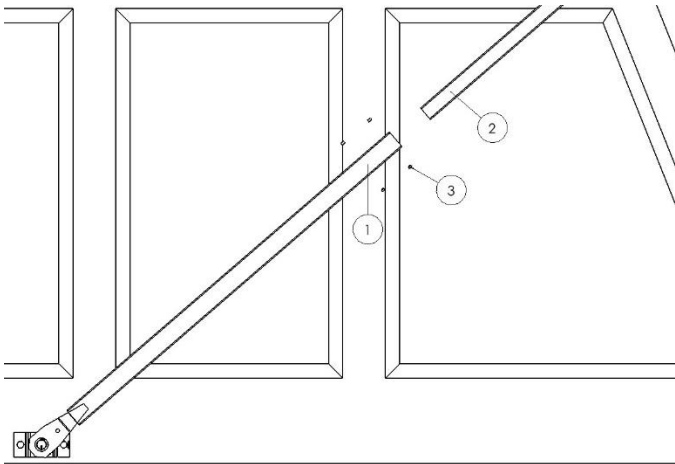

Figure 1.1

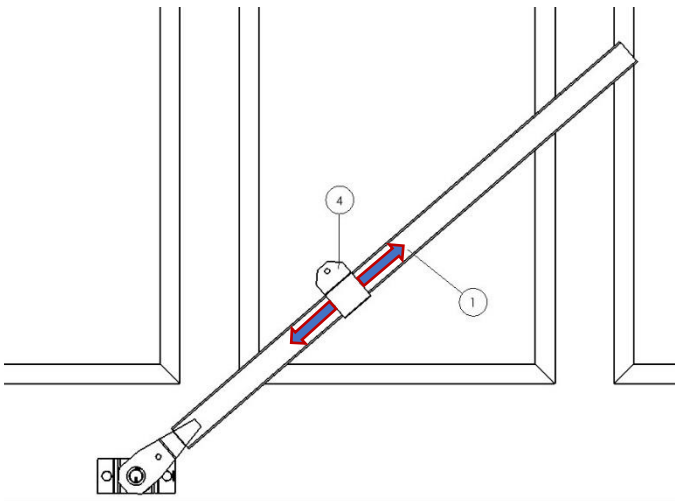

Figure 1.2

Finding the Tension Bow Pivot Point

Position the tension bow mounting bracket on the lower arm so that the bracket is near the middle of the dump box when the pivot arm is fully extended to the back of the dump box. Tighten the mounting set screws just enough to hold the bracket in place. Measure from the bolt in the mounting bracket to point A and point B shown in Figure 1.3. Adjust the mounting bracket until the bolt is the same distance from both points. Secure it tightly in place using the provided set screws.

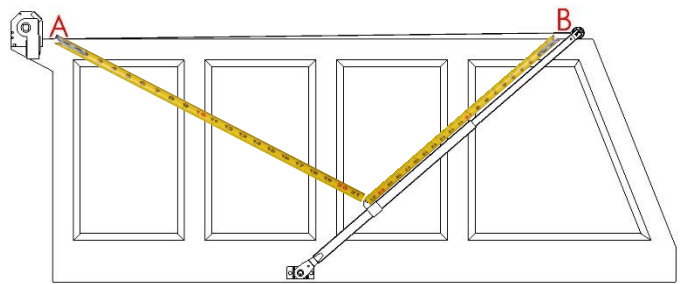

Figure 1.3

NOTICE

Leave 1-1/2" clearance between point A and the cab guard.

Assembling Mounting Bracket and Tab

If the tension bow mounting bracket (1) and tab (2) are not already assembled, use the 1/2" bolt (3) and nylock nut (4) to connect the tab to the mounting bracket as shown in Figure 1.4.

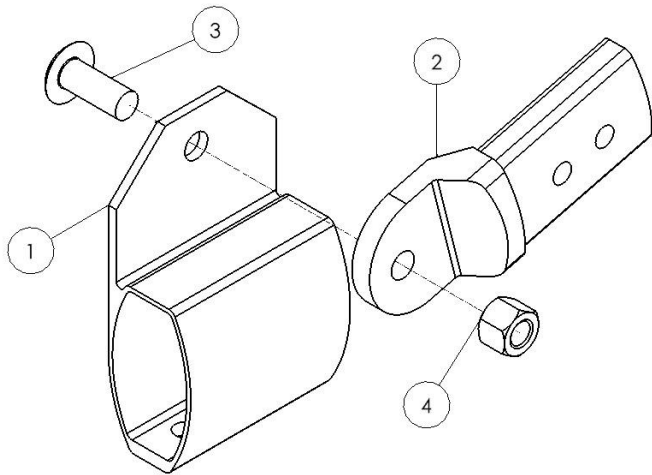

Figure 1.4

NOTICE

Do not over tighten the nylock nut the tab should rotate freely around the bolt.

Step 2: Installing the Tension Bow Arms

Slide one of the tension bow arms onto the tab connected to the mounting bracket. Swing the tension bow arm so that it is parallel to the tarp arm. Mark the tension bow arm at the seem between the corner and tarp arm. Remove the tension bow arm and cut both tension bow arms to the same length at this mark.

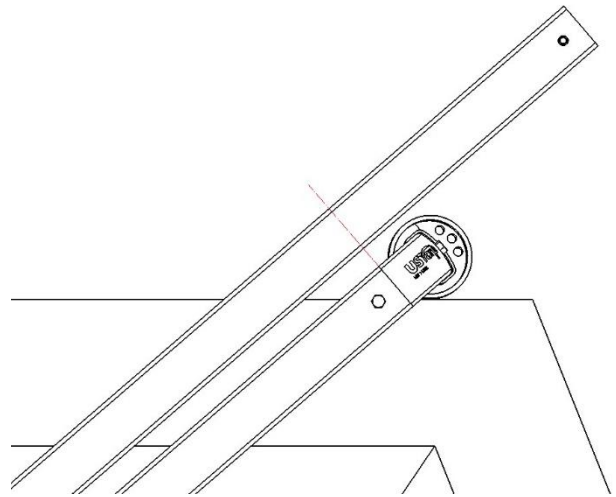

Figure 2.1

Drilling Mounting Holes

Slide the tension bow arm on the tab connected to the mounting bracket and mark the position of the two holes on the tab onto the tension bow arm. Remove the tension bow arm from the tab. On the other end of the tension bow arm insert the corner. Mark the position of the hole in the corner onto the tension bow arm. Remove the corner from the tension bow arm and drill the mounting holes at the marked locations on the tension bow arm using a 5/16" drill bit.

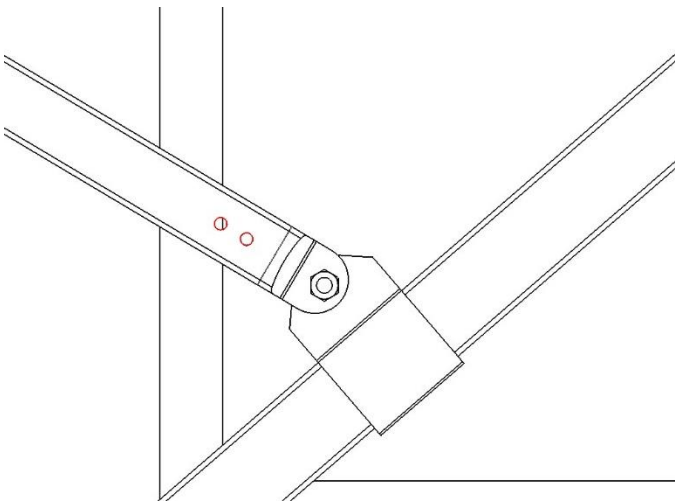

Figure 2.2

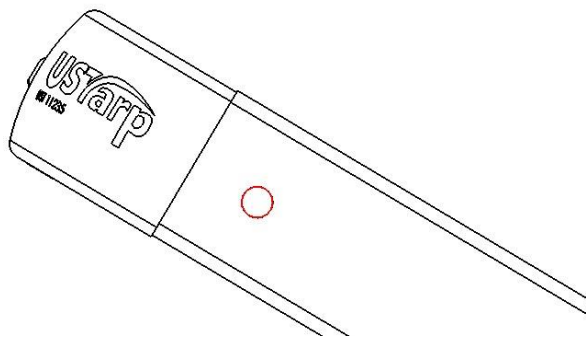

Figure 2.3

Mounting the Tension Bow Arms

Using the provided 5/16" socket cap screws and nylock nuts connect the tension bow arms to the mounting tab.

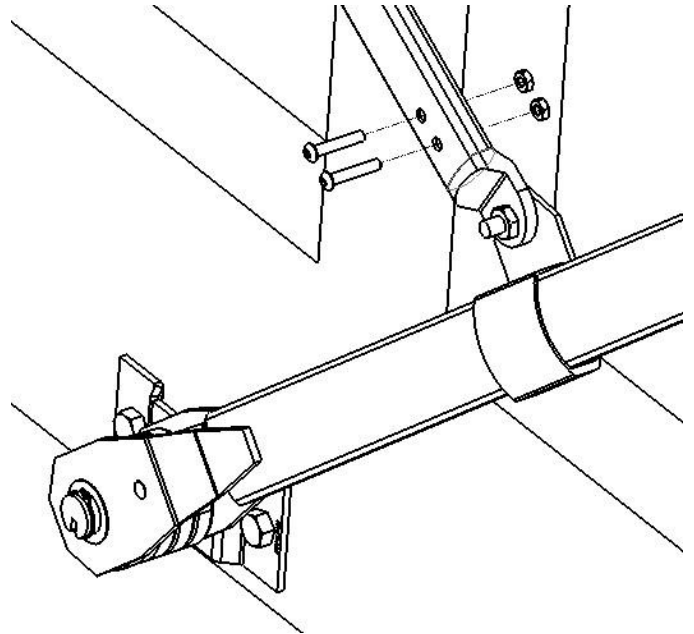

Figure 2.4

Step 3: Installing the Tension Bow Cross Tube

Measure the length of the tarp cross tube and cut the tension bow cross tube to the same length.

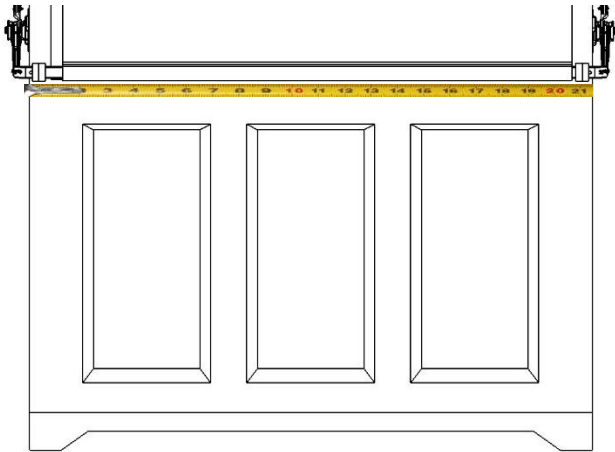

Figure 3.1

Drilling Mounting Holes

Insert the corners into each end of the tension bow cross tube and mark the location of the mounting holes on the corners onto the tension bow cross tube. Remove the corners and drill the mounting holes at the marked locations on the tension bow cross tube using a 5/16" drill bit.

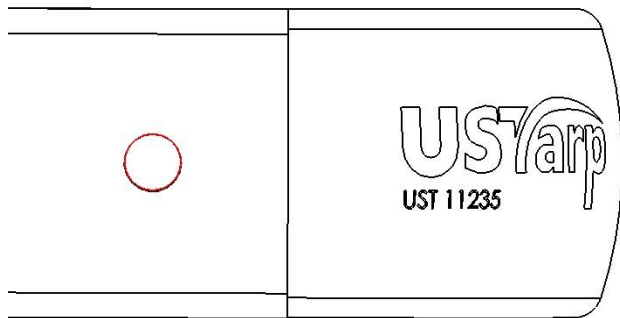

Figure 3.2

Connecting the Tension Bow Cross Tube

Slide the corners into both ends of the tension bow cross tube and secure them using the provided 5/16" socket cap screws and nylock nuts.

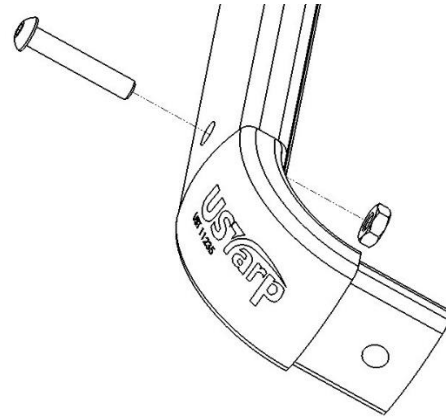

Figure 3.3

Rest the tension bow cross tube across the top of the dump box near the cab guard or rear. Swing one of the tension bow arms up to the cross tube. Insert the corner into the tension bow arm and secure them using a supplied 5/16" socket cap screw and nylock nut. Repeat this process with the other arm.

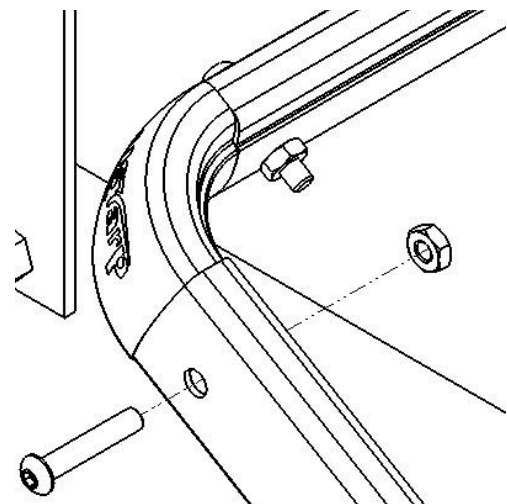

Figure 3.4

Step 4: Final Adjustments

Bow Positioning

Swing both the tension bow and tarp bow forward until they rest on the head assembly. The tension bow should rest in the middle of the head assembly opening and the tarp bow should be a little shorter than the tension bow as shown in Figure 4.1. If this is not the case reposition the mounting bracket until it is correct.

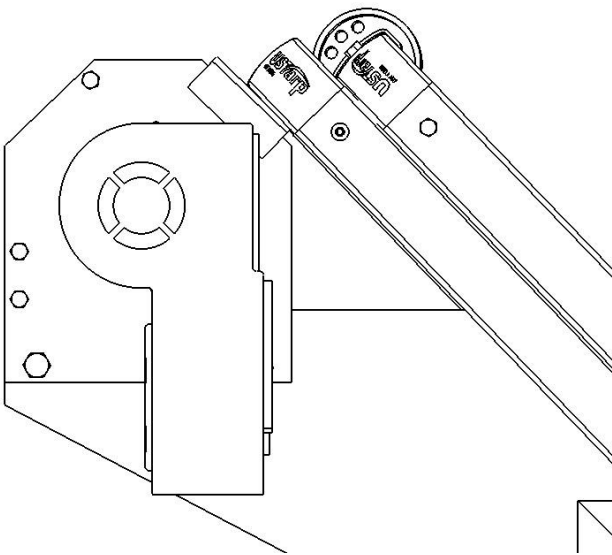

Figure 4.1

Bow Pinching

Check to see if the tension bow is catching on the lip of the head assembly as the tarp is wound in. In some cases, when the head assembly is mounted at the rear edge of the cab guard, the tension bow pinches the tarp against the lip of the head assembly which can result in tripping the circuit breaker or tearing the tarp. Adjust the tension bow mounting bracket to avoid this scenario.