

Pull Style Spring Return Tarp System

INSTALLATION INSTRUCTION MANUAL

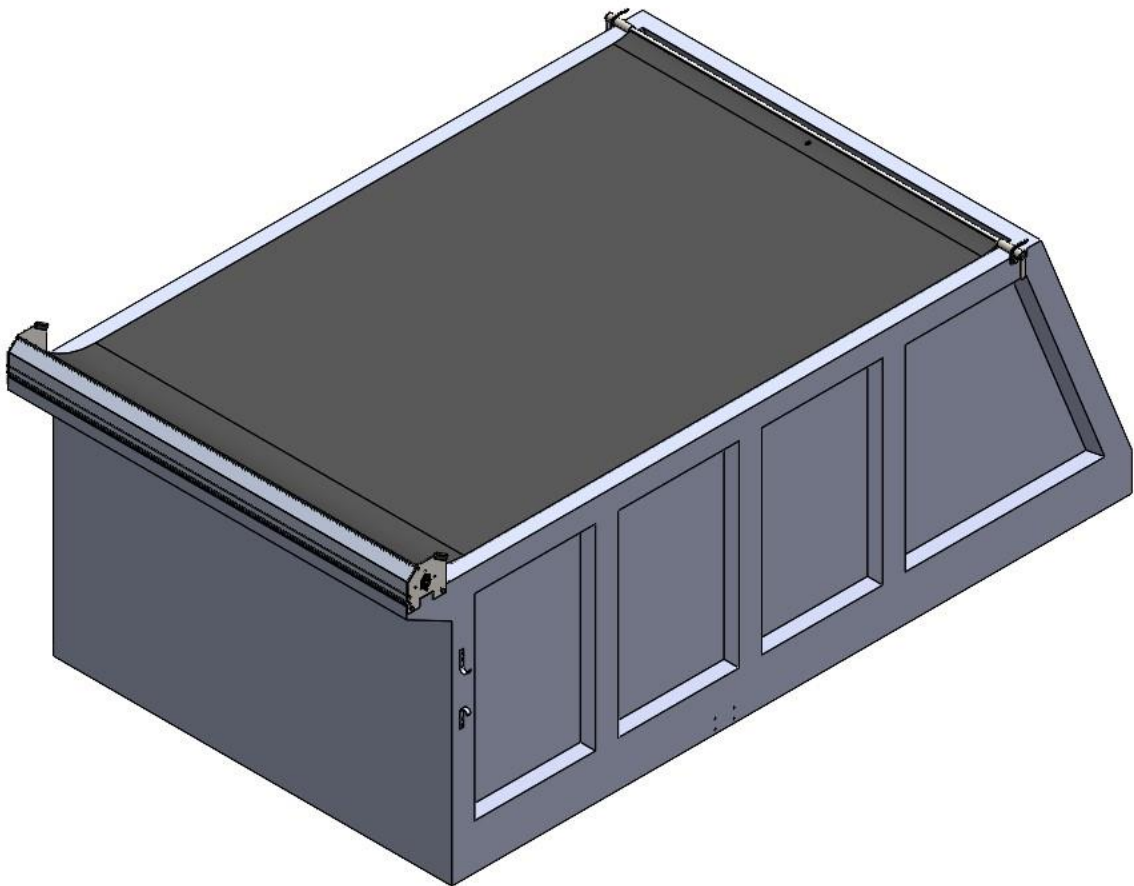

Table of Contents

SAFETY.....	3
STEP 1: INSTALLING THE TARP SPOOL ASSEMBLY	4
STEP 2: MOUNTING THE TAILGATE LATCHES	4
STEP 3: INSTALLING THE PULL ROPE	5
STEP 4: ATTATCHING THE J HOOKS	5
APPENDIX A: REASSEMBLING THE TARP SPOOL ASSEMBLY	6
INSTALLING THE MOUNTING BRACKETS	6
INSTALLING THE PULL STYLE AXLE	6
INSTALLING THE WIND DEFLECTOR	7
INSTALLING THE PULL BAR	8
WINDING THE TARP AXLE	9

SAFETY

Read this section carefully before proceeding. The following symbols may appear prior to certain safety related assembly and installation steps described in this manual.

FAILURE TO OPERATE AND INSTALL THIS UNIT AS INSTRUCTED MAY RESULT IN SERIOUS INJURY OR DEATH.

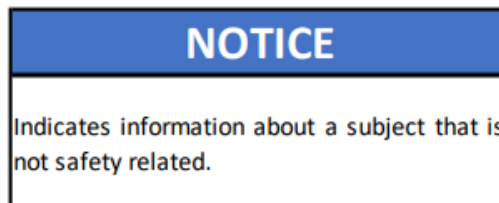
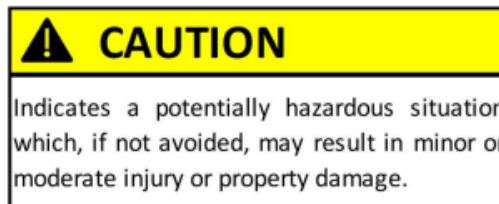
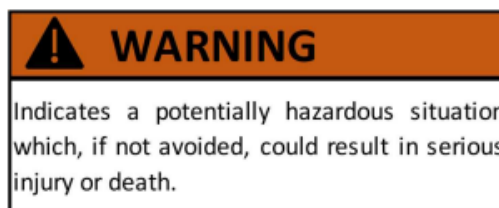
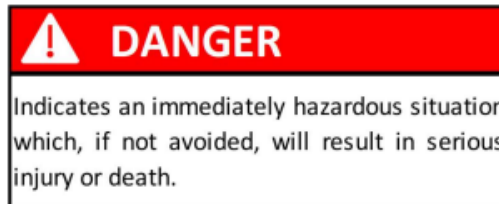

Step 1: Installing the Tarp Spool Assembly

Mounting the Tarp Spool Assembly



The pull style spring loaded tarp spool assembly should come pre-assembled and ready to install. To install the assembly, place the assembly (1) onto the dump box as far forward as possible on the exterior of the dump box. Mark the locations of the mounting holes and drill the holes into the dump box using a 1/2" drill bit. Mount the assembly to the dump box using the supplied 1/2" x 1" bolts (2) and 1/2" nuts (3).

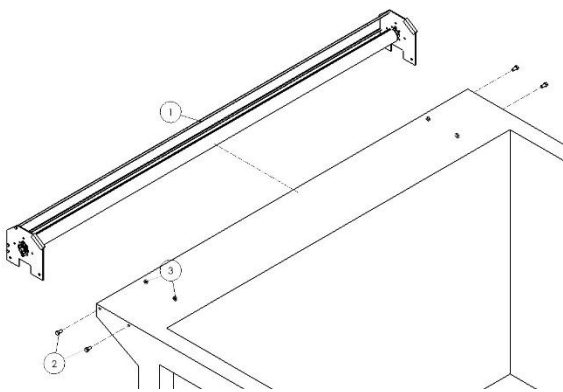

Figure 1.1

Step 2: Mounting the Tailgate Latches

Position the steel tailgate latches so that the hook opening faces the rear of the trailer. Move the tailgate latch as close to the rear as possible on the trailer to maximize tarp coverage. Also make sure to make the bottom of the hook opening as flush as possible with the top edge of the trailer. Mark the position of the mounting holes on the trailer. Using a 1/2" drill bit, drill out the mounting holes. Secure the tailgate latches to the trailer using the 1/2"-13 x 1-1/2" grade 5 zinc carriage bolt, 1/2" zinc plated SAE flat washer, and 1/2"-13 Nylock nut.

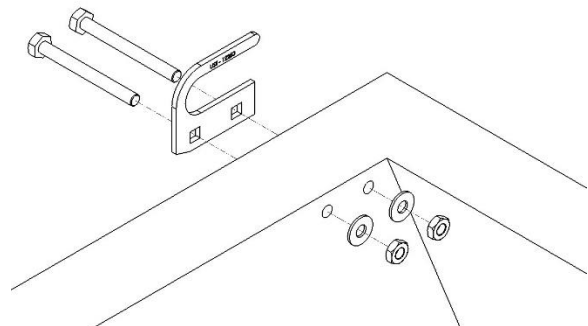

Figure 2.1

Step 3: Installing the Pull Rope

Feed the end of the supplied rope that is not attached to the bungee and ring through the center grommet on the tarp. Tie the rope so that it is secure.

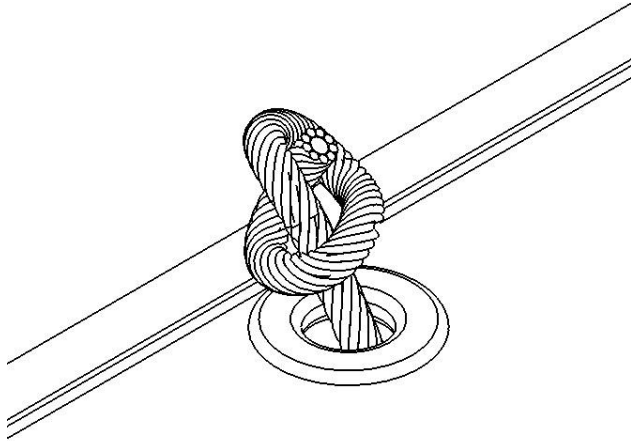

Figure 3.1

NOTICE

Do not use the bungee to connect the rope to the tarp.

Step 4: Attaching the J-Hooks

On the front driver side of the trailer (Figure 4.1) and on the center of the tailgate of the trailer (Figure 4.2), mount the J-hooks vertically using two #12 x 1" self-drilling screws. The J-hooks are used for securing the pull rope during transport. Wrap the pull rope around the J-hooks and secure the rope using the bungee and rings.

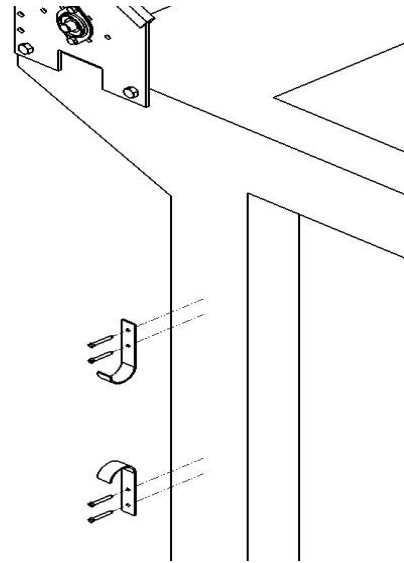

Figure 4.1

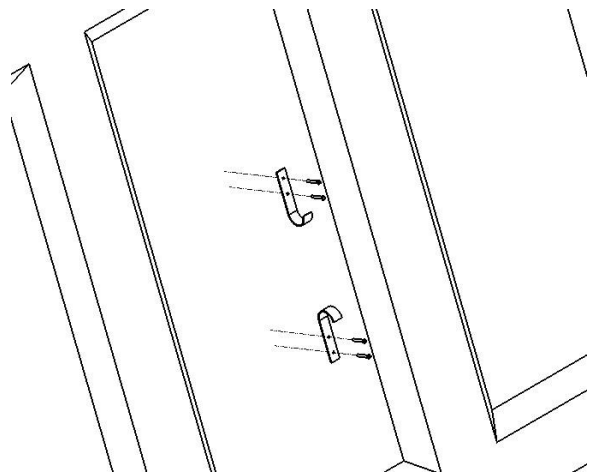

Figure 4.2

Appendix A: Reassembling the Tarp Spool Assembly

If the pull style tarp spool assembly needs to be reassembled the following instructions may be useful.

Installing the Mounting Brackets

Mount the two supplied tarp spool mounting brackets (2) as far forward as possible on the exterior of the dump box. Drill the two mounting holes 1-3/4" down from the top edge of the box. Use the supplied 1/2" x 1" bolts (1) and 1/2" nuts (3) to attach the tarp spool mounting brackets. (Figure 1.1)

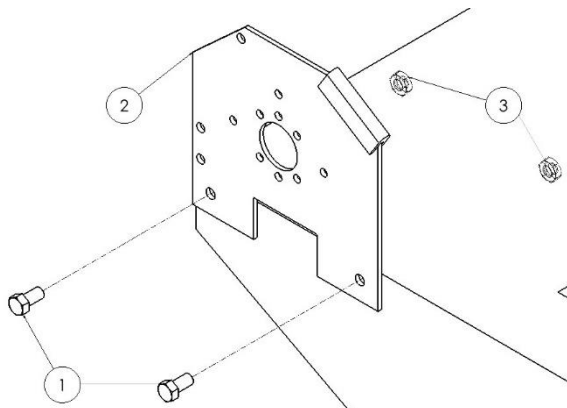
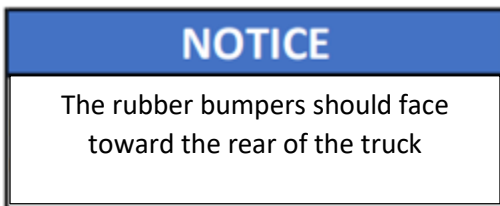

Figure A.1

Installing the Pull Style Axle

On the passenger side mounting bracket mount the threaded stationary pull style adaptor plate using the supplied 5/16" x 1" he bolts and nylock nuts.

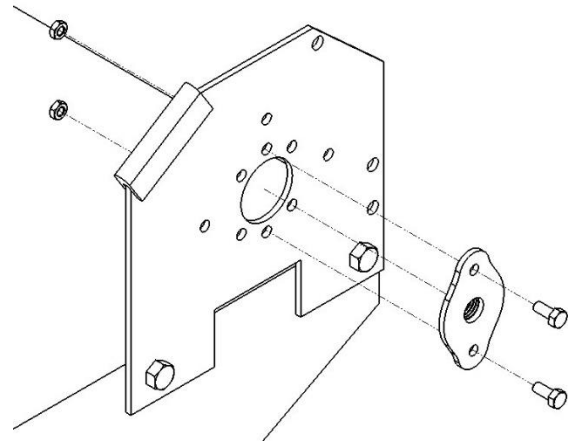

Figure A.2

Insert the non-threaded end of the tarp axle (2) into the driver side mounting bracket (1). Swing the axle so that it is in line with the treaded adaptor plate (3).

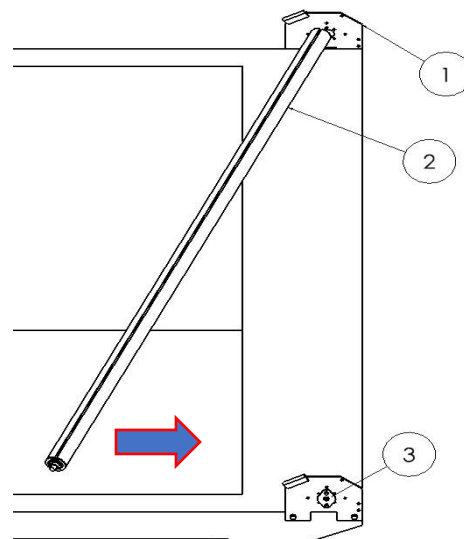

Figure A.3

Thread the axle into the adaptor plate until it is tight.

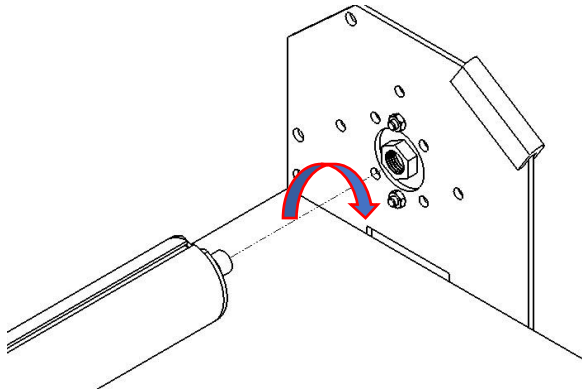

Figure A.4

On the driver side mounting bracket mount the 3/4" axle bearing using the supplied 5/16" x 1" hex bolts and nylock nuts.

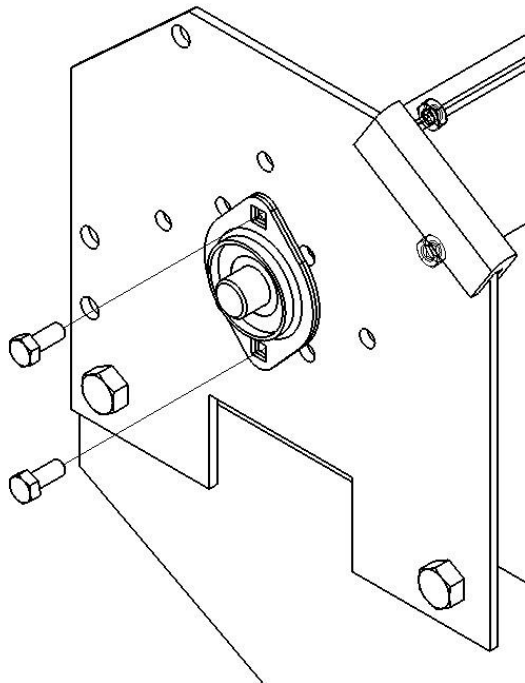

Figure A.5

Installing the Wind Deflector

Attach the wind deflector to the tarp spool mounting brackets using the supplied 5/16" x 1-1/4" self-threading bolts.

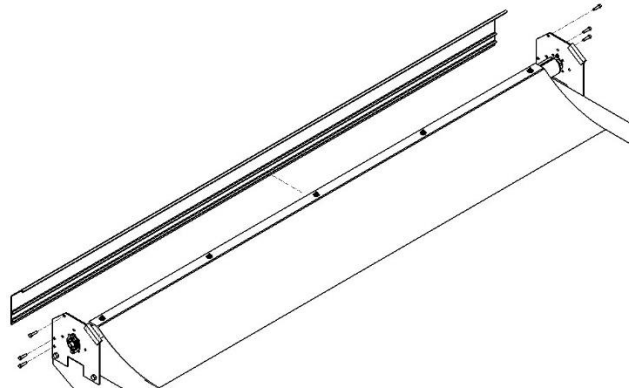

Figure A.6

Installing the Pull Bar

Measure the pull bar and verify that it is 12" longer than the width of the tarp. If it is too long cut it to size. On one end of the rear pull bar (1), slide on the 6" plastic handle (2). At the same end, line up the mounting hole on the tarp guide (3) with the slot on the pull bar and secure it with an M10x1.5x25mm hex bolt (4). (Figure 3.1)

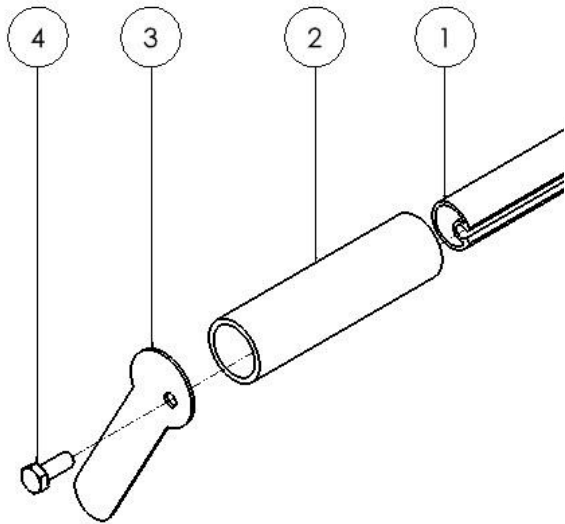

Figure A.7

If your tarp has a splined end, feed the spline through the slot on the pull bar from the open end (Figure A.7). Otherwise, if your tarp has a pocket on it, feed the pull bar through tarp pocket (Figure A.8).

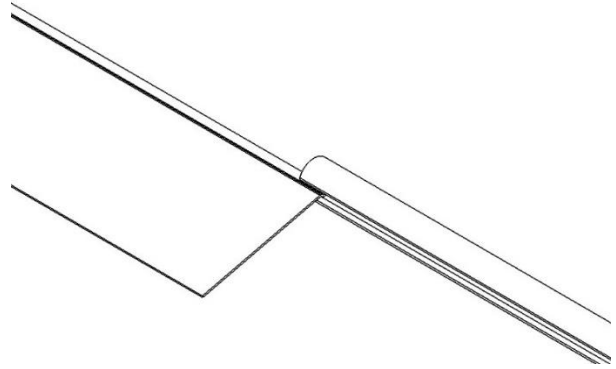

Figure A.8

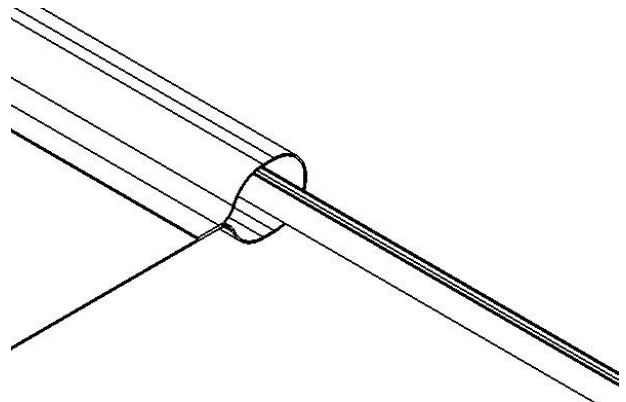

Figure A.9

On the open end place the 6" plastic handle and tarp guide and secure them with the M10x1.5x25mm bolt. The pull bar should look like the one shown in Figure 3.4.

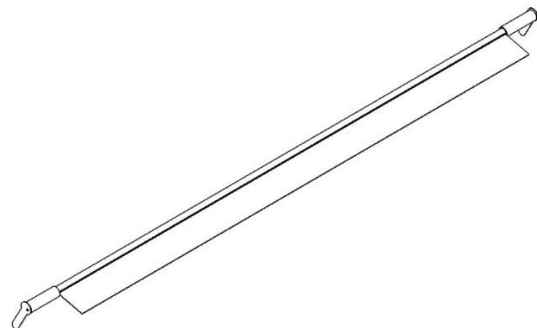

Figure A.1

Winding the Tarp Axle



Wind the tarp axle clockwise from the driver side (Figure A.11) of the dump box according to the number of turns listed in Table A.1. Have one person hold the axle so that it does not unwind while the other person attaches the tarp via the tarp grommets, 1/4" carriage bolts (1), 1/4" washers (2), and 1/4" nylock nuts (3). (Figure A.12)

System Width	Number of Turns
< 87"	29
88" < Width < 93"	32
> 94"	35

Table A.1

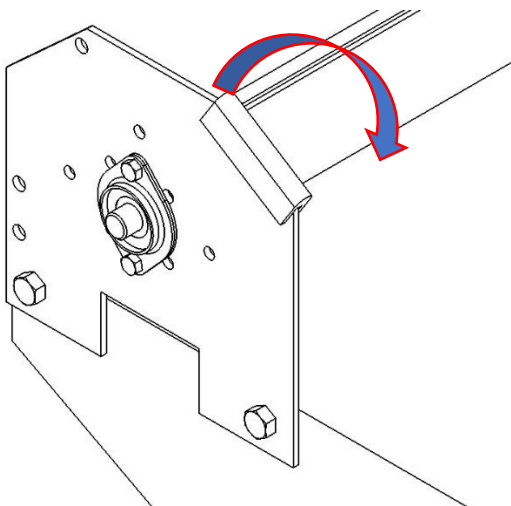

Figure A.11

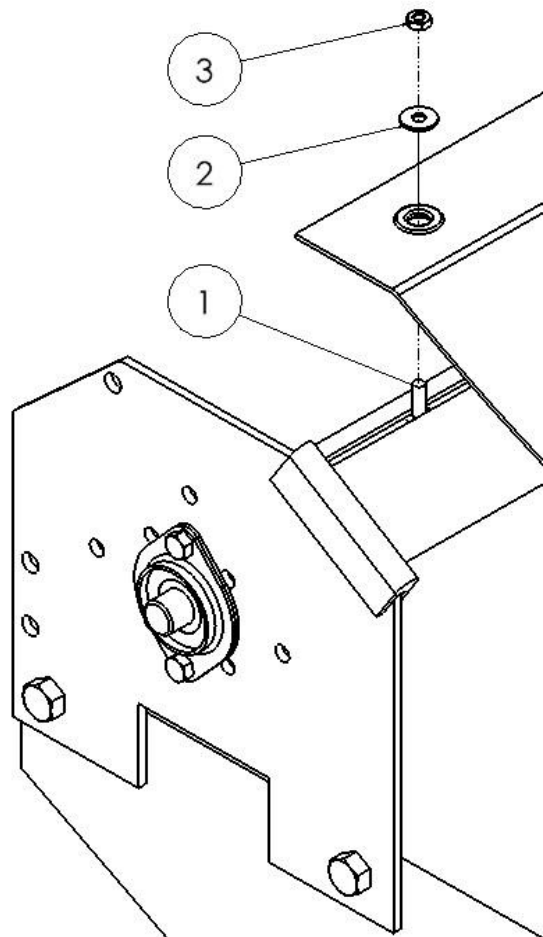

Figure A.12

Have the same person who attached the tarp hold the end of the tarp. Slowly release the tarp axle and let the system wind in the tarp.

⚠ CAUTION

Releasing the tarp to wind freely or too quickly may cause damage/injury to the system/people nearby