

DROP IN CAB LEVEL MANUAL CRANK

INSTALLATION INSTRUCTION MANUAL

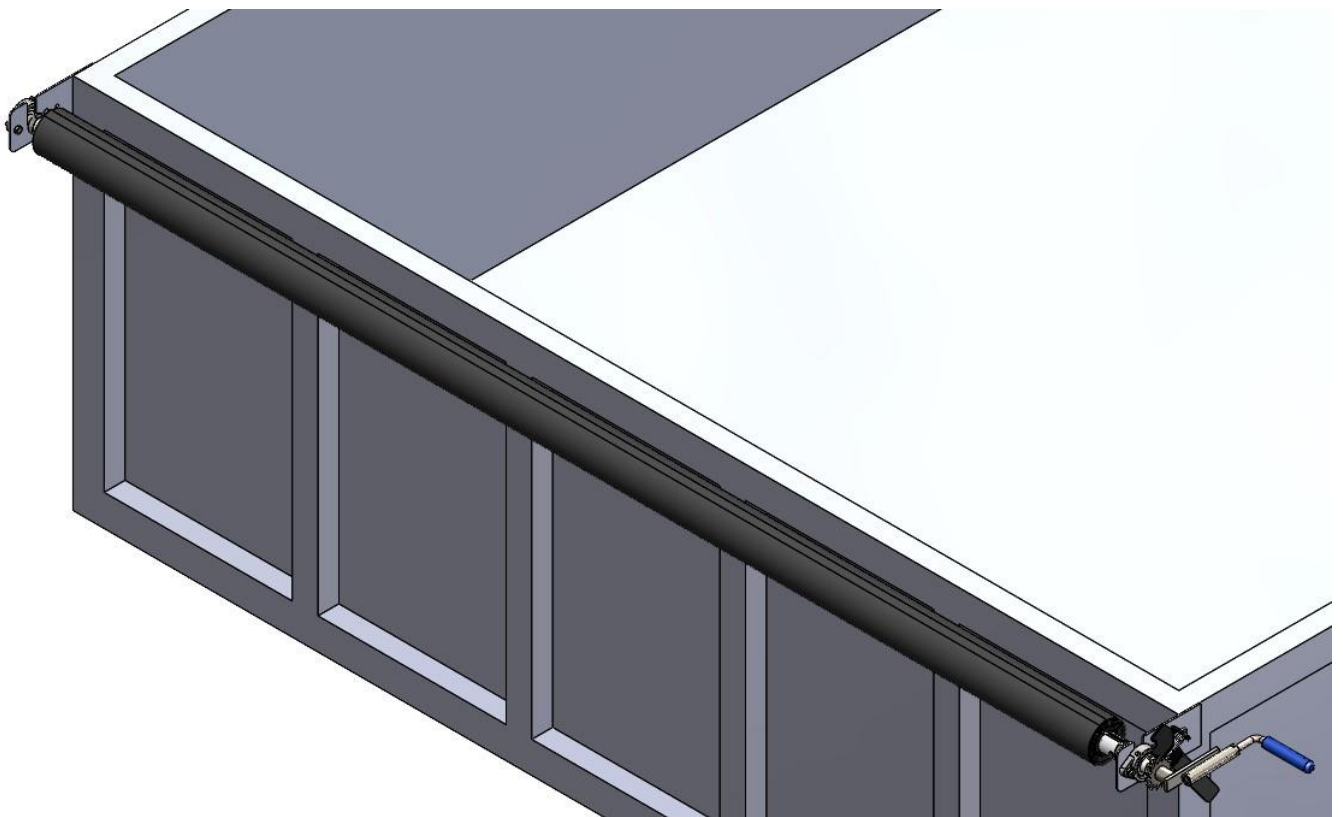



Table of Contents

SAFETY.....	3
STEP 1: INSTALLING THE AXLE	4
STEP 2: INSTALLING THE BEARINGS	4
STEP 3: INSTALLING THE LOCKING RATCHET HANDLE	5
STEP 4: INSTALLING THE ROPE KIT	6

SAFETY

Read this section carefully before proceeding. The following symbols may appear prior to certain safety related assembly and installation steps described in this manual.

FAILURE TO OPERATE AND INSTALL THIS UNIT AS INSTRUCTED MAY RESULT IN SERIOUS INJURY OR DEATH.

 DANGER
Indicates an immediately hazardous situation which, if not avoided, will result in serious injury or death.

 WARNING
Indicates a potentially hazardous situation which, if not avoided, could result in serious injury or death.

 CAUTION
Indicates a potentially hazardous situation which, if not avoided, may result in minor or moderate injury or property damage.

NOTICE
Indicates information about a subject that is not safety related.

Step 1: Installing the Axle

Drop the pre-loaded axle into the mounting slots oriented so that the ratchet handle is on the driver side. Ensure that the bearing is on the outside of the mounting plate.

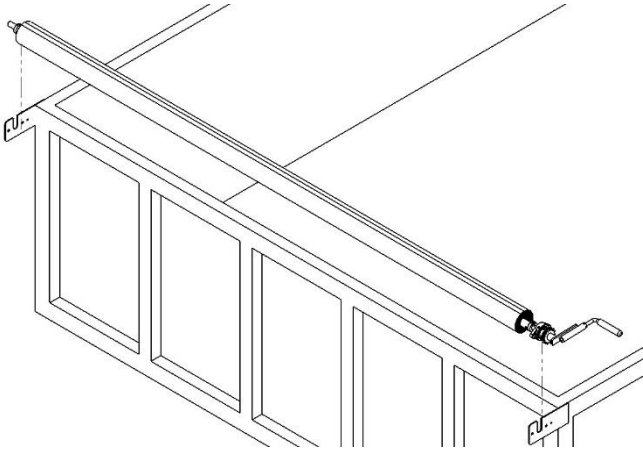

Figure 1.1

Step 2: Installing the Bearings

Place the provided 3/4" cast iron flange bearing over the spool shaft on the passenger side so that it is on the outside of the mounting bracket.

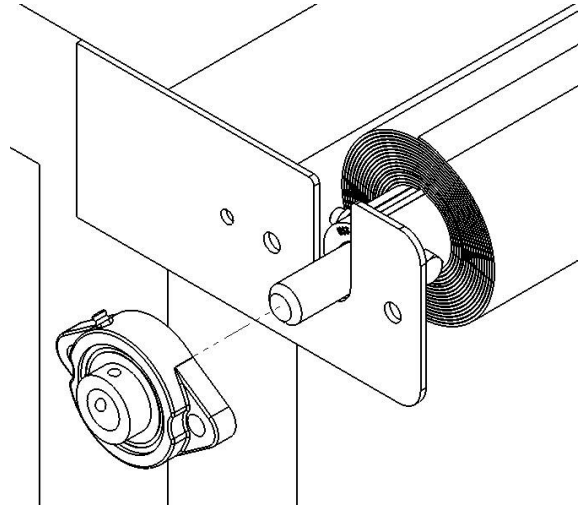

Figure 2.1

Slide the 5/16" - 18 x 1" hex bolts into the mounting holes for the passenger side bearing. Make sure that the heads of the bolts are on the inside of the mounting bracket. Using the provided 5/16" - 18 nylock nuts, secure the bearing to the mounting bracket.

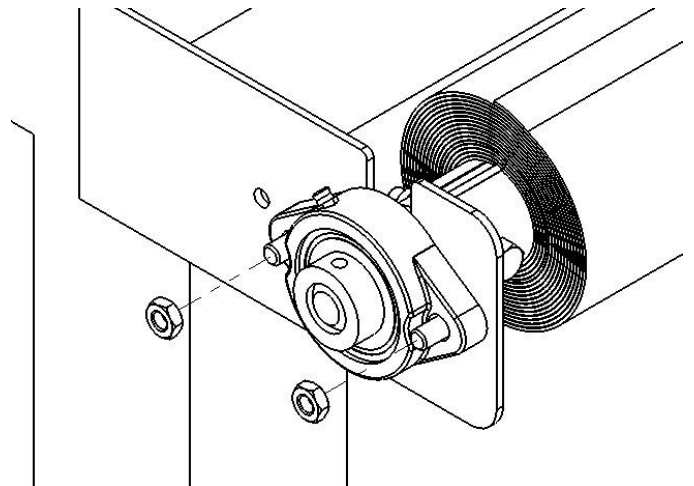

Figure 2.2

On the driver side, slide the 5/16" – 18 x 1-1/2" hex bolt through the mounting hole closest to the rear of the trailer. In the remaining mounting hole use a 5/16" - 18 x 1" hex bolt. Make sure that the heads of the bolts are on the inside of the mounting bracket. Secure the bearing to the mounting bracket using the provided 5/16" – 18 nylock nuts.

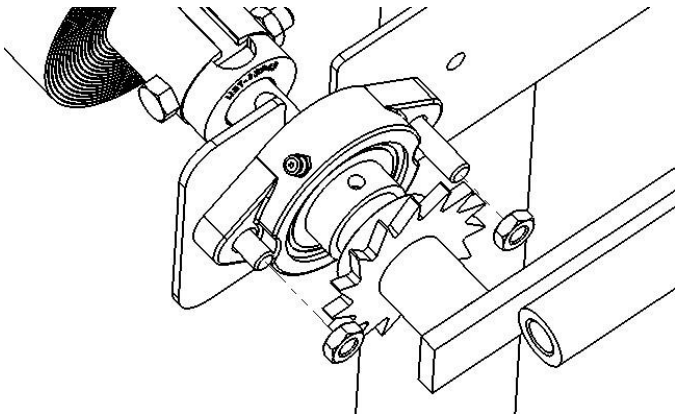

Figure 2.3

Make sure that your tarp is centered on the trailer. Once the tarp is centered on the trailer tighten the set screws on the bearings.

Step 3: Installing the Locking Ratchet Handle

Slide a 1/4" – 20 x 3/4" hex bolt into the ratchet handle mounting hole on the driver side such that the head of the bolt is on the inside of the mounting bracket. On the outside of the bracket slide, in order, the 1/4" plastic washer, the locking handle, and the 1/4" - 20 nylock nut. Secure the handle but do not over-tighten, the handle should be able to rotate about the bolt.

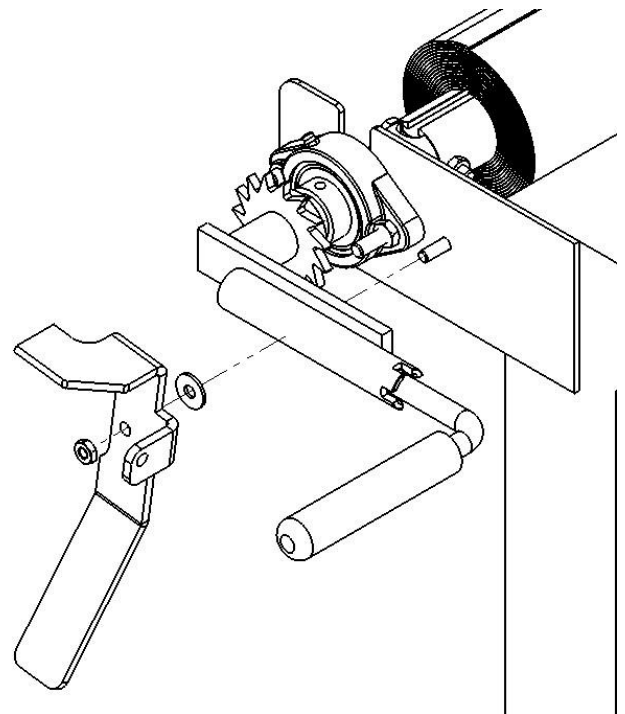

Figure 3.1

Loop the spring through the hole on the flange of the ratchet handle. Loop the other end of the spring over the 1-1/2" hex bolt on the bearing. Turn the leftover 5/16" nylock nut onto the end of the end of the 1-1/2" hex bolt so that the end of the nut is flush with the end of the bolt and holds the spring on the bolt.

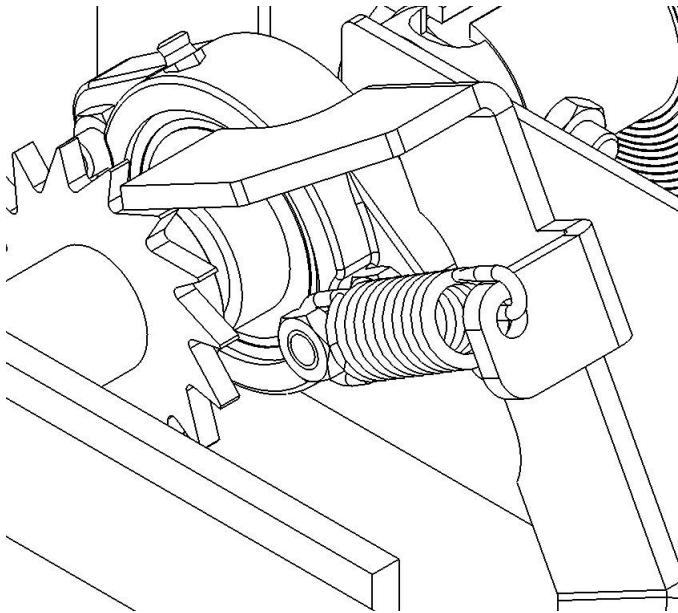

Figure 3.2

Step 4: Installing the Rope Kit

Feed the end of the supplied rope that is not attached to the bungee and rings through the center grommet on the tarp. Tie the rope so that it is secure.

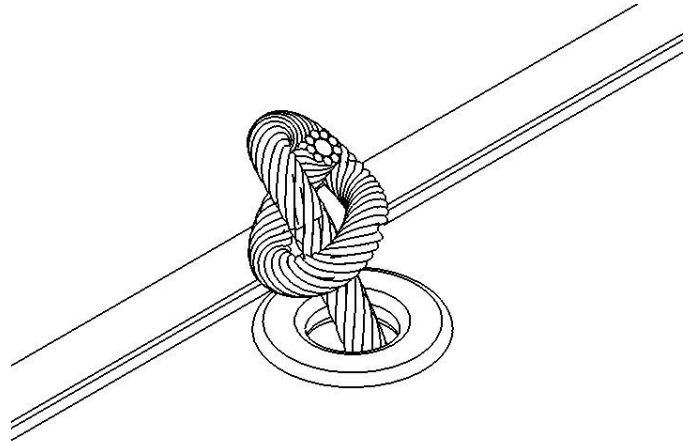

Figure 4.1

NOTICE

Do not use the bungee to connect the rope to the tarp.

Mount the J-hooks using two #12 x 1" self-drilling screws. One set should be mounted on the front driver side of the trailer (Figure 4.2) and the other set should be mounted on the center of the tailgate of the trailer (Figure 4.3). The J-hooks are used for securing the pull rope during transport. Wrap the pull rope around the J-hooks and secure the rope using the bungee and rings.

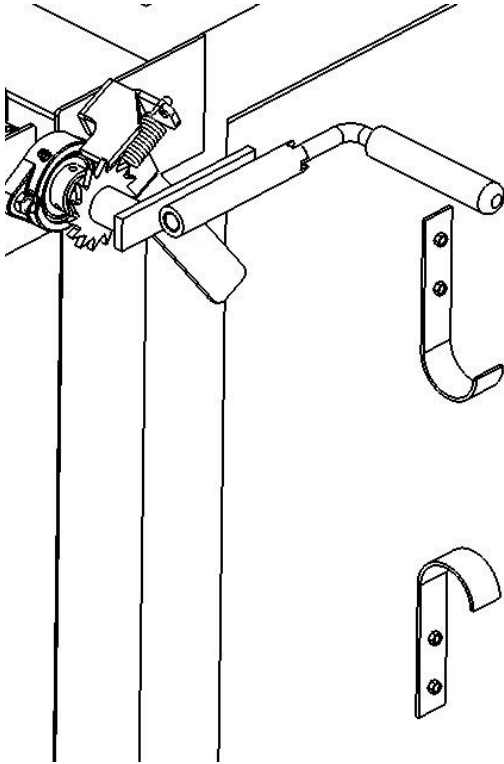

Figure 4.2

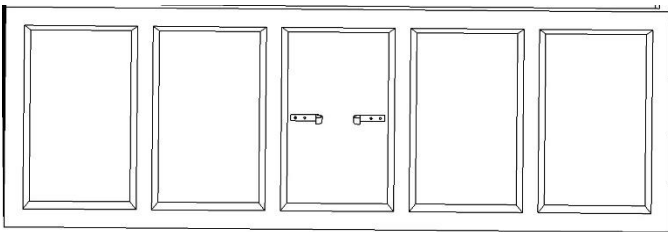

Figure 4.3