

16580 Fabric Ag End Cap

INSTALLATION INSTRUCTION MANUAL

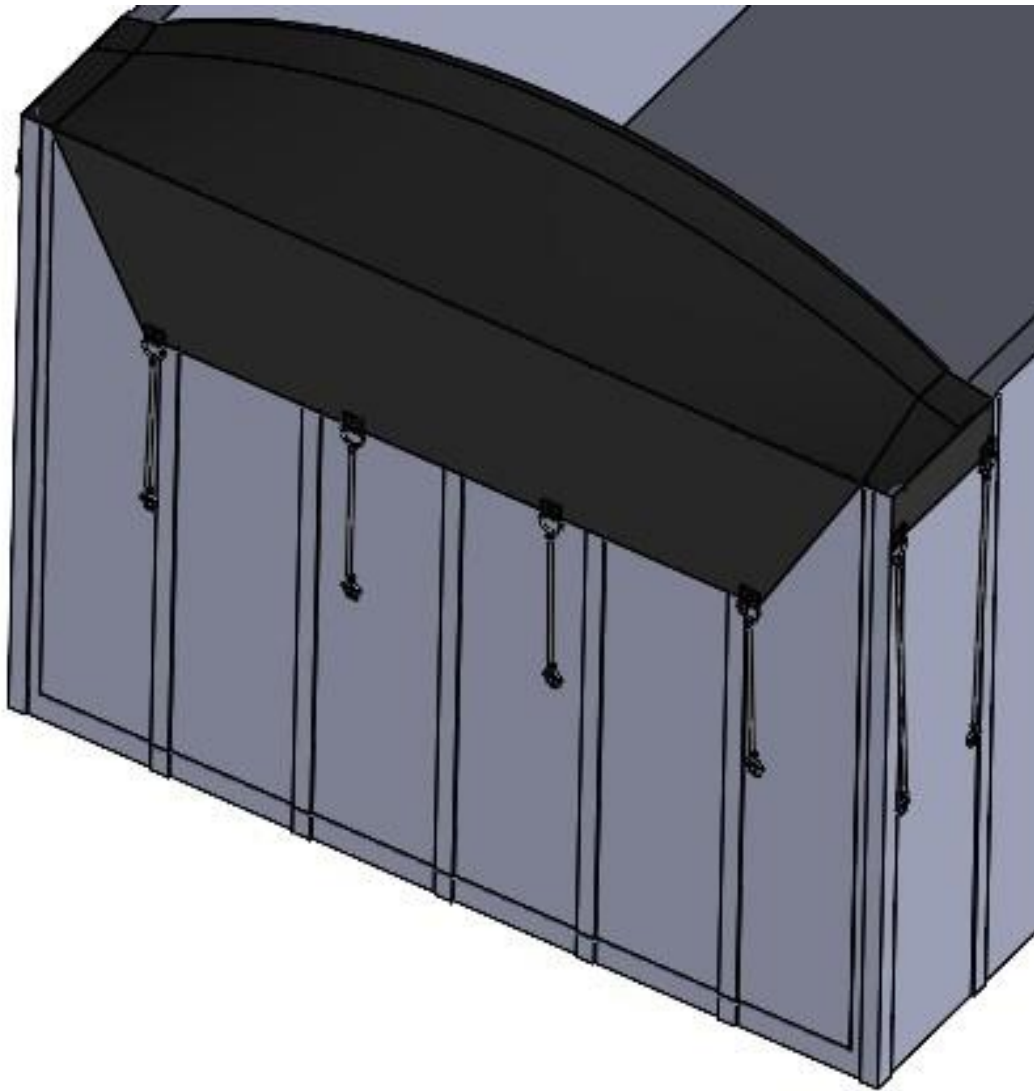

Table of Contents

SAFETY.....	3
STEP 1: POSITIONING THE REAR BOW	4
STEP 2: INSTALLING THE BOWS	5
STEP 3: INSTALLING THE END CAP	6

SAFETY

Read this section carefully before proceeding. The following symbols may appear prior to certain safety related assembly and installation steps described in this manual.

FAILURE TO OPERATE AND INSTALL THIS UNIT AS INSTRUCTED MAY RESULT IN SERIOUS INJURY OR DEATH.

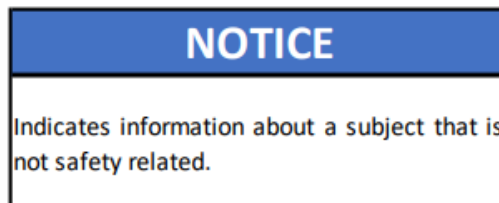
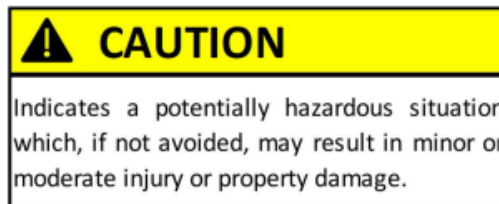
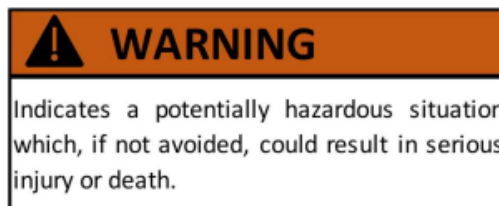
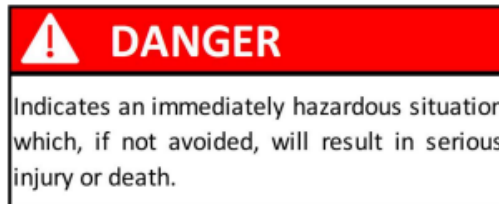

Step 1: Positioning Rear Bow

The 16580 Fabric Ag End Cap requires a bow that is positioned 16" from the rear of the trailer (or the end it is to be installed on). To achieve this an already installed bow can be moved to this position or a new bow can be installed.

To install the bow, on the top rail, mark 16" from the outside face of the rear of the trailer. This mark will be referred to as the spacing mark.

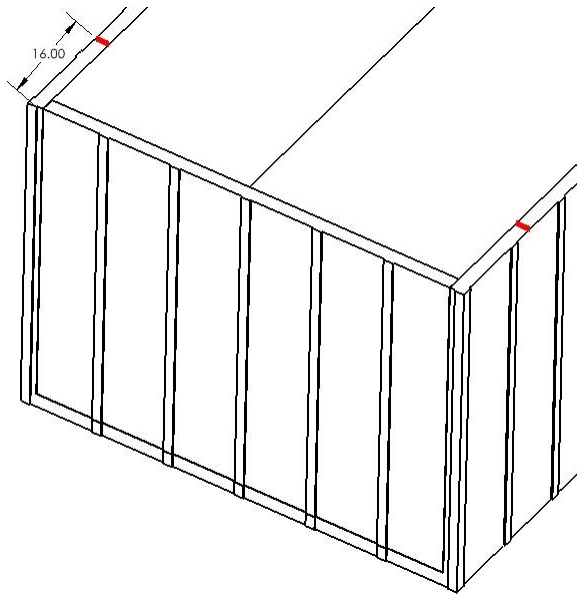

Figure 1.1

Next the depth at which the bow brackets must be mounted needs to be determined. Use Table 1.1 to determine this depth based on your trailers bow rise, rail width, and trailer width.

RAIL	HIGH RISE 12"		LOW RISE 8"	
	96"	102"	96"	102"
1"	2-15/16	3	3-5/16	3-5/16
2"	2-7/16	2-1/2	3	3-1/16
3"	1-15/16	2-1/16	2-11/16	2-3/4
4"	1-7/16	1-9/16	2-3/8	2-7/16
5"	15/16	1-1/8	2-1/16	2-1/8
6"	1/2	11/16	1-3/4	1-7/8

Table 1.1

Using this distance, mark the depth of the brackets. Place the bottom of the bracket on the depth mark and center on the spacing mark.

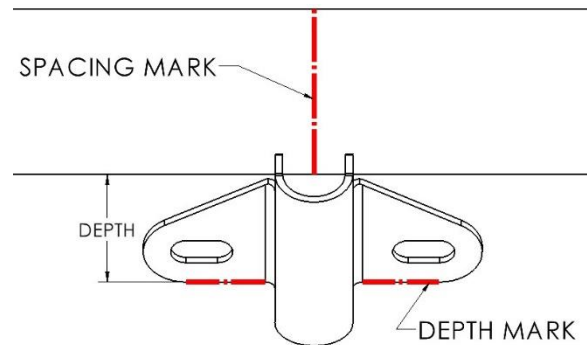

Figure 1.2

NOTICE

The depths marked red in Table 1.1 should be marked so that the top of the mounting slot is as close to the top of the rail as possible. The exact measurement will cause the slots to sit higher than the rail allows.

Now, mark the center of the bracket mounting slots. Drill out the mounting holes using an 11/32" drill bit and mount the brackets using the supplied 3/8 x 1-1/2" self-tapping hex bolts.



1-(800) 249-0297
 technicalsupport@ustarp.com
 www.ustarp.com

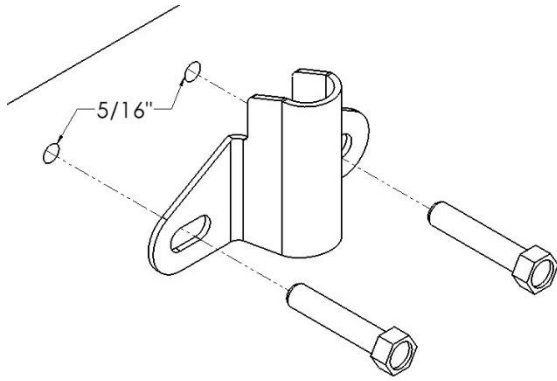

Figure 1.3

Step 2: Installing the Bows

Insert the welded bow and shank into the mounting bracket.

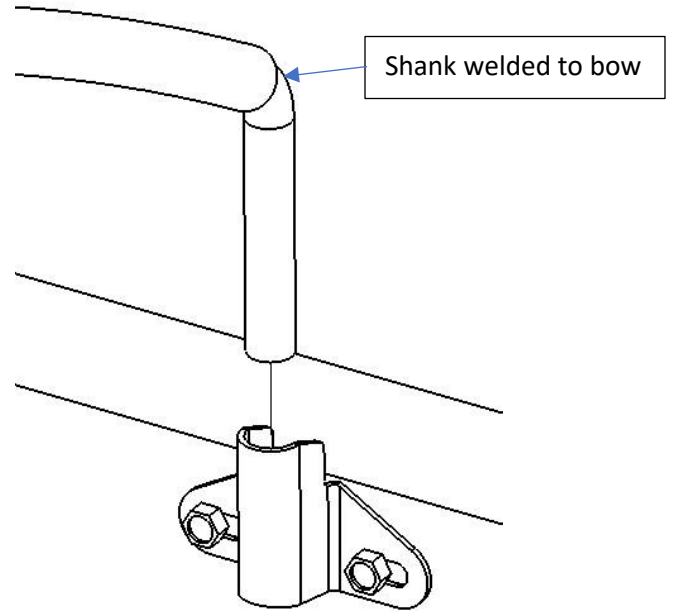

Figure 2.1

Place the loose bow shank into the bracket on the opposite side of the box. Align the bow with the loose bow shank and mark the bow as shown in Figure 2.2

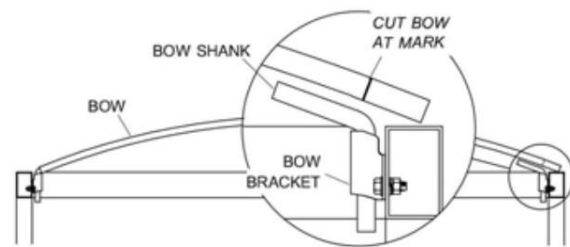

Figure 2.2

Remove the bow. Cut the bow at the mark and grind the end until smooth.

Place the loose bow shank into the end of the bow and insert both shanks into the mounting brackets. Ensure that the bow fits into the brackets properly adjust where necessary.

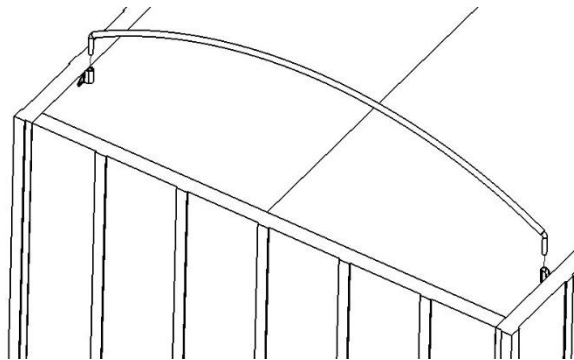

Figure 2.3

Step 3: Installing the End Cap

Remove the bow from the brackets and slide the bow into the pocket of the end cap.

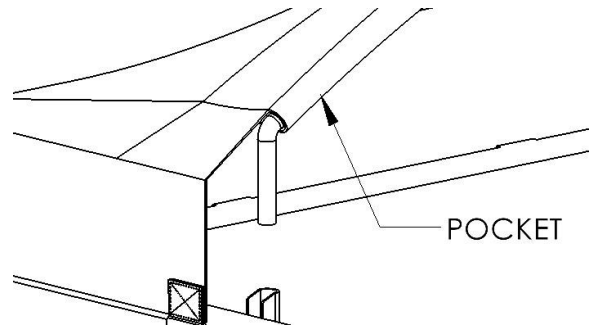

Figure 3.1

Reinstall the bow into the brackets and pull the flaps of the end cap taught to ensure that the end cap will properly cover the trailer.

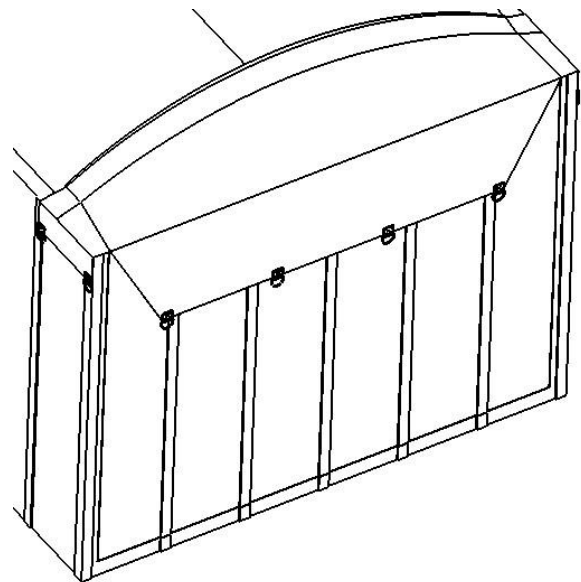

Figure 3.2

Finally connect the tarp to the trailer via the D-rings and bungee cords.

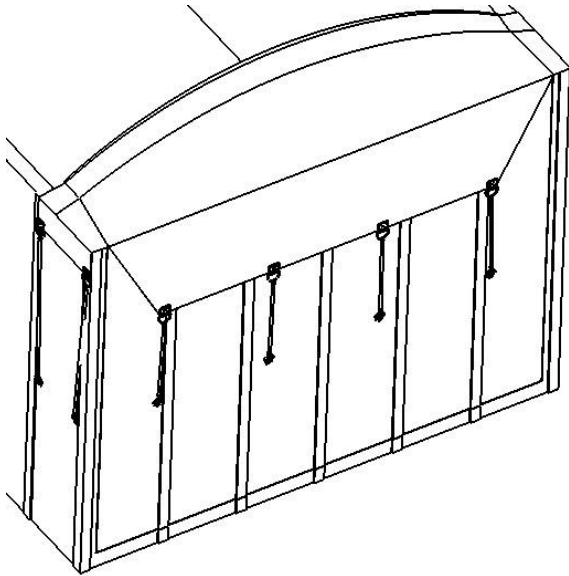

Figure 3.3

Open and close the dump door of the trailer a few times and ensure that the tarp does not bind with or hinder the operation of the door. Adjust as necessary.