

Universal Ag End Cap

INSTALLATION INSTRUCTION MANUAL

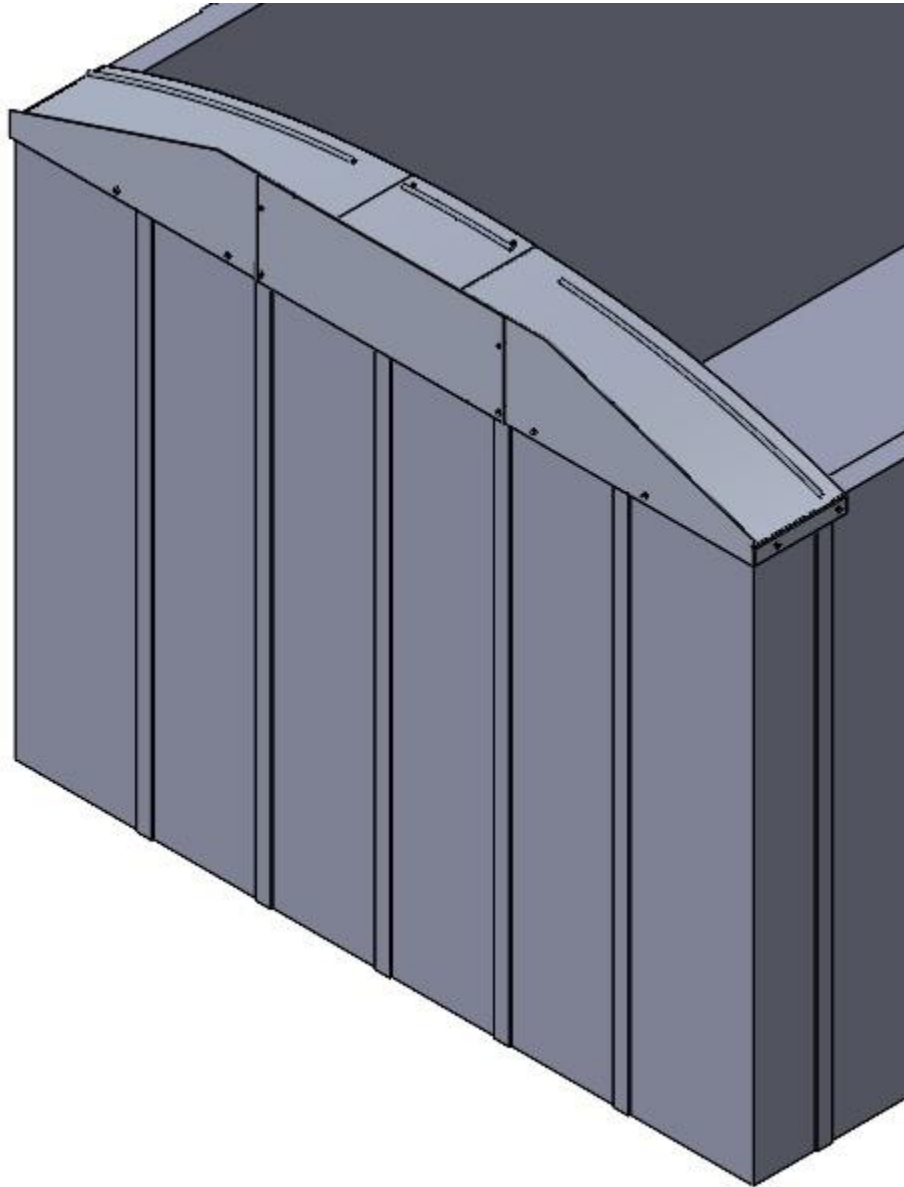

Table of Contents

SAFETY.....	3
STEP 1: MARKING THE DRIVER & PASSENGER CAPS	4
STEP 2: MOUNTING THE SIDE CAPS	5
STEP 3: MOUNTING THE MID CAP	6
STEP 4: SEALING THE SEAMS	8

SAFETY

Read this section carefully before proceeding. The following symbols may appear prior to certain safety related assembly and installation steps described in this manual.

FAILURE TO OPERATE AND INSTALL THIS UNIT AS INSTRUCTED MAY RESULT IN SERIOUS INJURY OR DEATH.

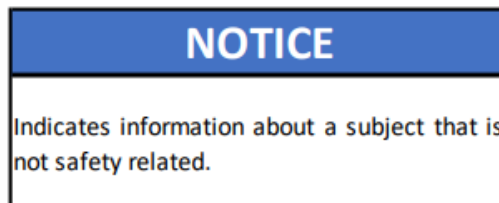
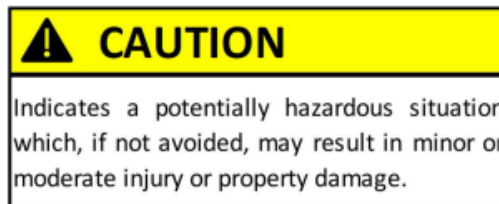
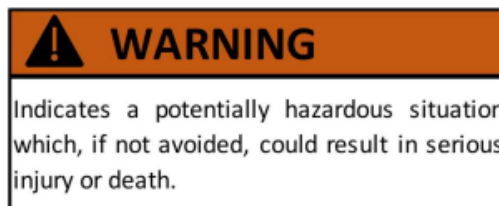
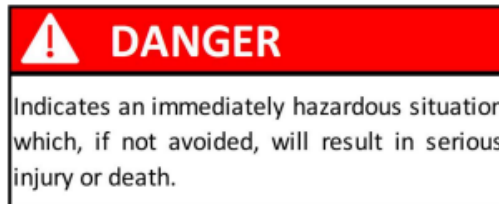

Step 1: Marking the Driver & Passenger Caps

Measure and mark 3" and 11" from front of Driver and Passenger End Cap about 1" up on the sides.

NOTICE
For non-square nose trailers, make the first mark far enough back to contact the side of the trailer when drilled.

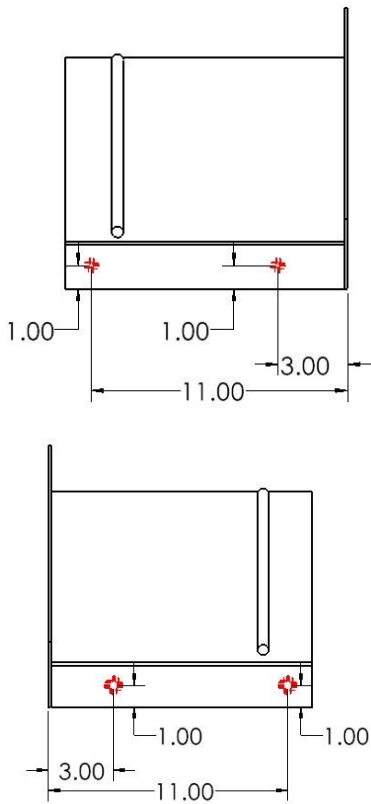

Figure 1.1

From the inside of the Driver and Passenger End Cap, measure out 8-1/2" and mark about 1" up from bottom. From outside of Driver and Passenger End Cap, measure in 14" and mark about 1" up from bottom.

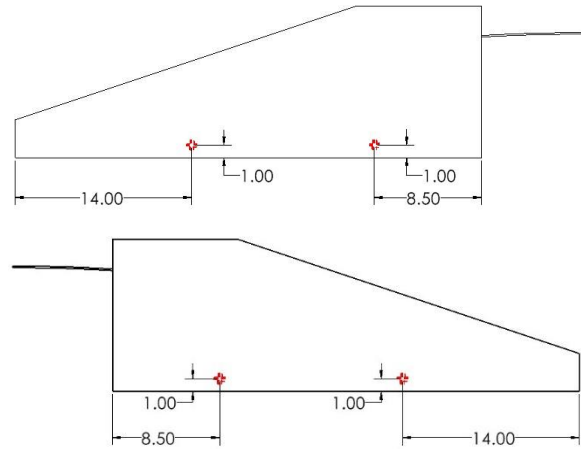

Figure 1.2

Optional: Marking and Cutting Fillers for Radius Corners

Place the fillers on top of the trailer and position them so that the flanges are aligned with the edges of the trailer as shown in Figure 1.3. Trace the outer radius on to the bottom of the fillers.

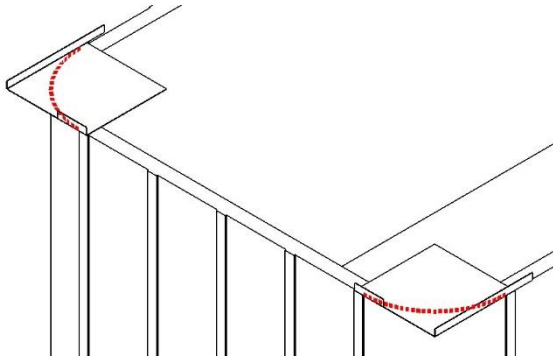

Figure 1.3

Remove the fillers from the trailer and cut them along the marked line. Keep the portion that has the flanges still attached.

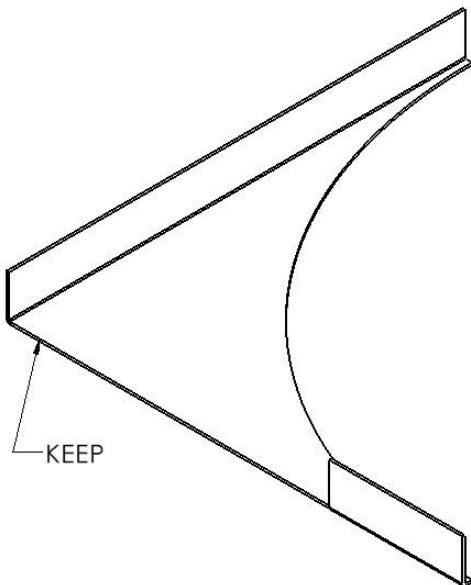

Figure 1.4



1-(800) 249-0297
technicalsupport@ustarp.com
www.ustarp.com

Step 2: Mounting the Side Caps

Place the driver and passenger side caps on the trailer. Clamp the caps so they are level with the top of the trailer and flush with the front and sides of the trailer.

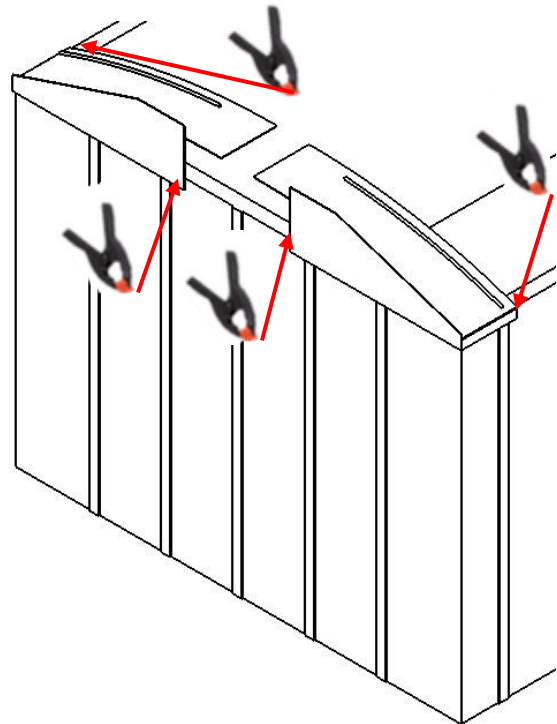

Figure 2.1

Optional: Mounting the Fillers for Radius Corners

Slide the cut fillers into the exposed corners of the adjustable end cap so that the flanges of the fillers sit behind the flanges on the end cap and the bottom of the fillers are flush with the bottom of the end caps.

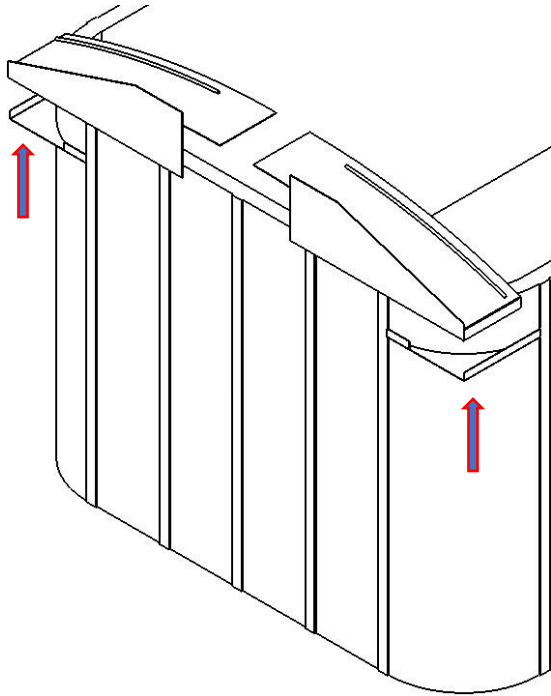

Figure 2.2

Connect cap and fillers to trailer using 5/16"-18 cutting thread screws as shown in Figure 2.3

Keeping the side caps flush with the front and side of the trailer, pre-drill holes at the marked locations using a 9/32" drill bit.

Using a 1/2" drive socket and the 5/16"-18 cutting thread screws, bolt the side caps to the trailer.

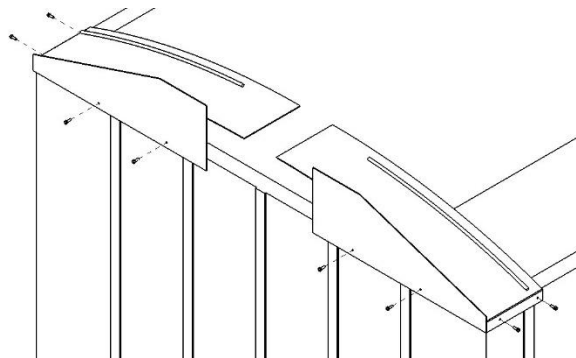

Figure 2.3



1-(800) 249-0297
 technicalsupport@ustarp.com
 www.ustarp.com

Step 3: Mounting the Mid Cap

Place the mid cap on top of the side cap flanges. Center the mid cap then press down on the mid cap until it's top is flush with the top of both side caps. Using clamps temporarily fix the mid cap in place.

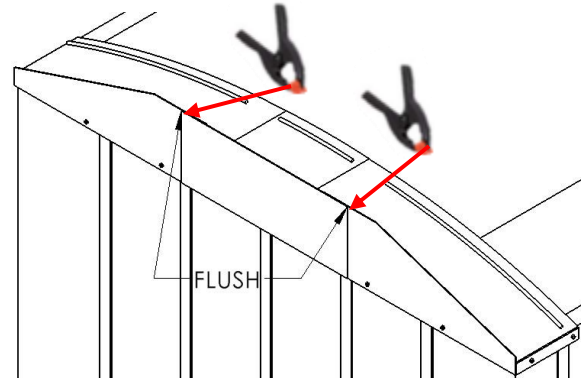

Figure 3.1

Make a mark on both sides of the mid cap that is approximately 8-1/2" from the bottom of the mid cap and 1/2" from the edges of the mid cap.

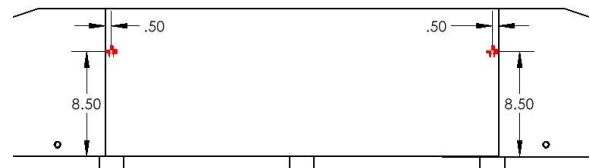

Figure 3.2

Using a #12 x 1" Self-Drilling Screw and a 5/16" drive socket, fix the mid cap to the side caps at the marked locations.

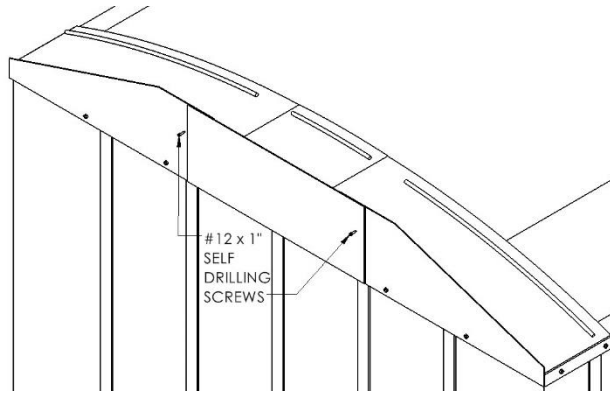

Figure 3.3

To fix the bottom of the Mid Cap, pre-drill a hole with a 9/32" bit on each side of the Mid Cap so that the hole will contact the trailer and its respective Side Cap. The hole should be about 1" from the bottom.

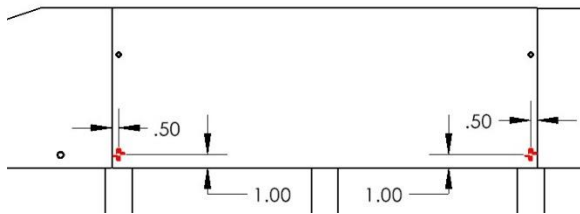

Figure 3.4

Using the 5/16"-18 thread cutting screws, bolt the bottom of the mid cap to the side caps and trailer.

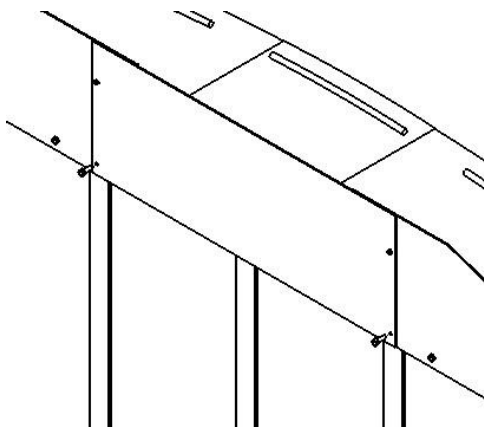

Figure 3.5

Un-clamp the mid cap. At this point the mid cap should be self-supporting.

Using a #12 x 1" Self-Drilling Screw, fix Mid Cap rise plate to the Side Cap flanges 1/2" behind rise plate rib as shown.

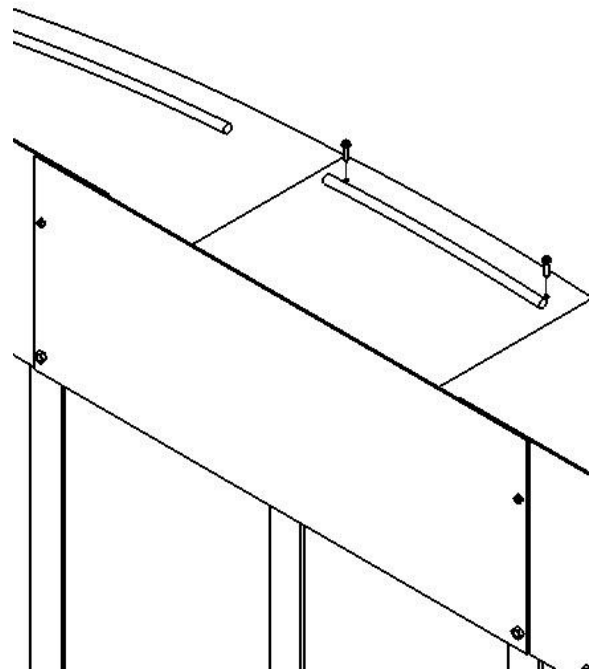

Figure 3.6



1-(800) 249-0297
 technicalsupport@ustarp.com
 www.ustarp.com

Step 4: Sealing the Seams

Using 100% Silicone cartridge, seal all the seams and gaps on the top of the end cap.

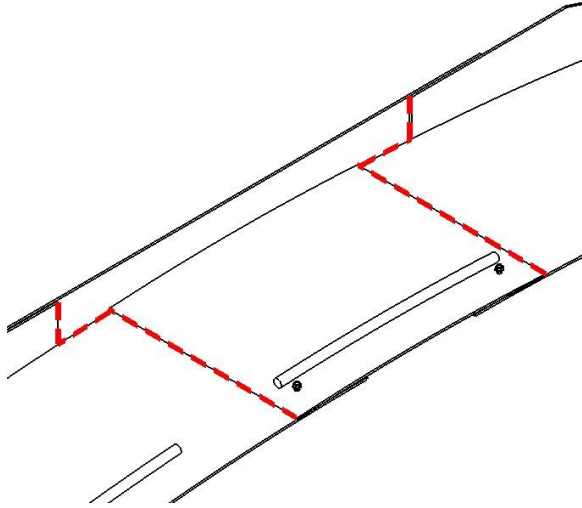

Figure 4.1

Also seal all the way around the bottom edge of the end cap.

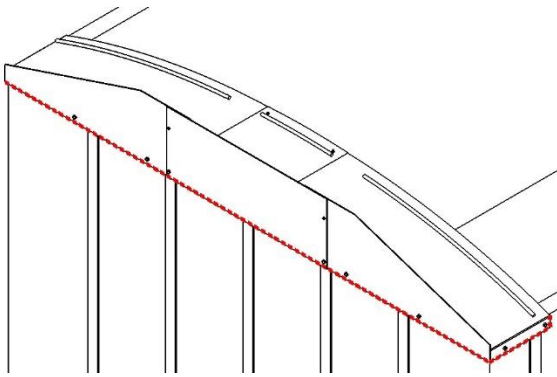

Figure 4.2



1-(800) 249-0297
technicalsupport@ustarp.com
www.ustarp.com